

Water Meter

Model WM30B/100B

Choice of integrated control or remote control dependent upon user's preference.



Photo: Model WM30B

[Remote control]

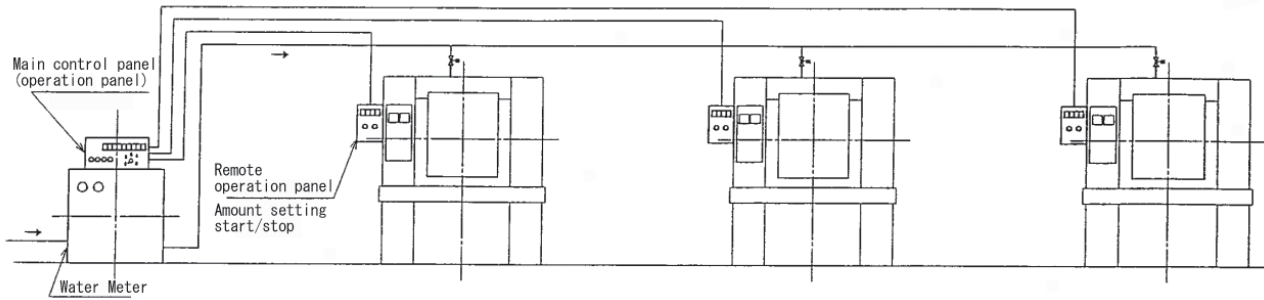

Furnishes remote control panels on several mixers through which amount setting, start/stop and checking actual flowing amount are done.

[Integrated control]

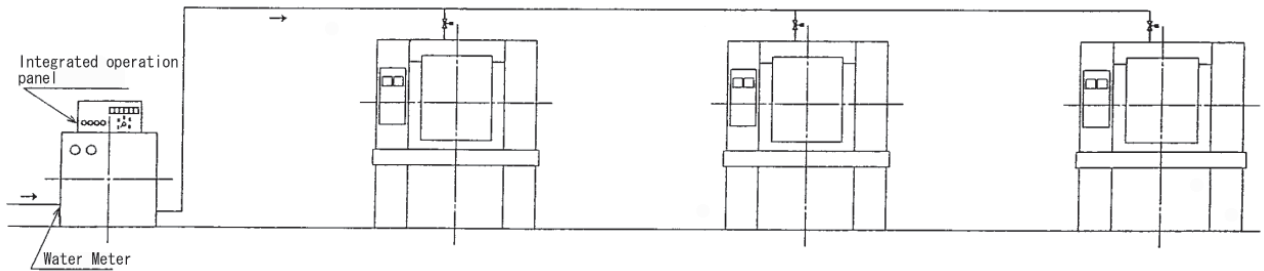

Amount setting, start/stop and checking actual flowing amount are done from Water Meter with simplified piping to mixers.

Specifications

Model	WM30B	WM100B
Water to be used	City water (0 - 40°C)	
Pipe diameter	25A	40A
Flow amount (50Hz)	30L/min (H=10m)	100L/min (H=10m)
Flow amount (60Hz)	36L/min (H=12m)	120L/min (H=12m)
Metering Accuracy	±0.5% or less (10 - 30L supply)	±0.5% or less (30 - 70L supply)
Metering accuracy	±0.3% or less (more than 30L supply)	±0.3% or less (more than 70L supply)
Setting range	10 - 999.9L (0.1L increments)	
Motor	AC200V 3Ph. 0.75kW 2P	AC200V 3Ph. 1.5kW 2P
Machine weight	150kg	200kg

Specifications and dimensions may be subject to change without prior notice.

OSHIKIRI MACHINERY LTD. <http://www.oshikiri.com/>

4, Kirihara-cho, Fujisawa-shi, Kanagawa, 252-0811 Japan
 Phone: 0466-44-6184 Fax: 0466-44-6187 E-mail: intl@oshikiri.com

Oshikiri Corporation of America
 10425 Drummond Road, Philadelphia, Pennsylvania 19154-3898
 Phone: 215-637-6005 Fax: 215-637-6041 E-mail: oshikiri-production@msn.com